

# Land Use Bylaw 3357/2006



North

Scale 1:5,000

© The City of Red Deer





- |              |                            |              |                                |
|--------------|----------------------------|--------------|--------------------------------|
|              | Land Use District Boundary |              | Historical Preservation Sites  |
| <b>R1</b>    | Land Use District          |              | Historically Significant Sites |
|              | Exception to District      | <b>HP-32</b> | Historical Site Number         |
| <i>e(ii)</i> | Exception Number           |              | City Boundary                  |
| •••          | Exempted from District     | <b>123</b>   | Civic Address                  |
| <i>2a</i>    | Exempted Number            |              | Railway                        |
| V18          | Height Overlay District    |              | Proposed Lots                  |
| D95          | Density Overlay District   |              |                                |
| s            | Secondary Suite Permitted  |              |                                |

Printed on 2020/12/04  
**Land Use Districts**  
**R11**  
 NE¼ Sec2 38-27-W4

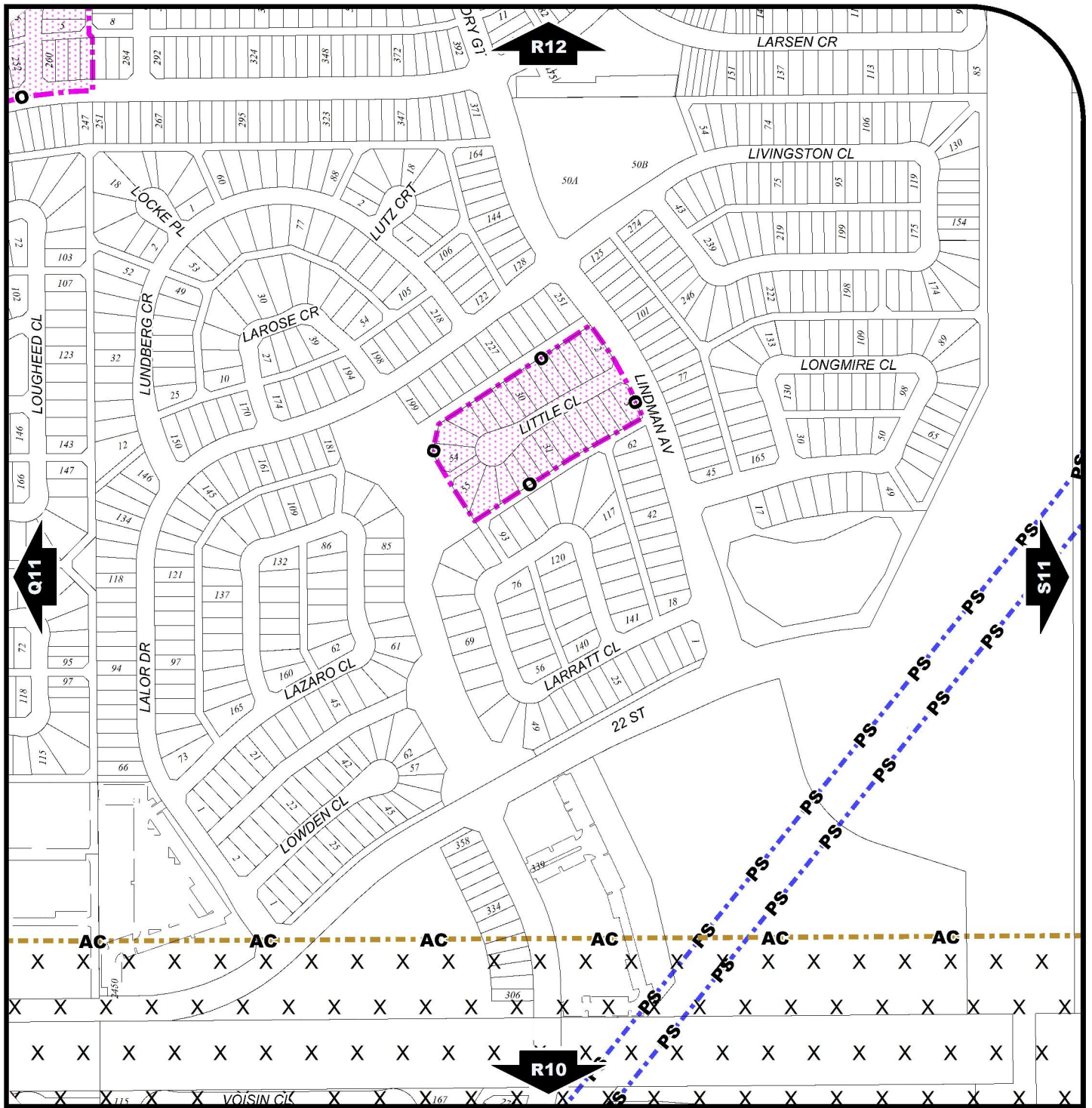
Refer to Constraints Map





# Land Use Bylaw 3357/2006

  
 North  
 Scale 1:5,000  
 © The City of Red Deer  

-  Escarpment Area
-  Flood Fringe
-  Floodway
-  Landfill Site (approximate)
-  Landfill Setback
-  Wastewater Treatment Plant Setback
-  Major Entry Area
-  Pipeline Setback
-  AltaLink Consultation/Potential Constraints Area
-  Overlay District

-  Gaetz - Ross Heritage Area
-  Restricted Development Area
-  Railway Setback (15m)
-  Railway Setback (30m)
-  Business Improvement Area
-  Historical Preservation Sites
-  Historically Significant Sites
-  HP-32 Historical Site Number
-  123 Civic Address
-  Railway

-  Proposed Lots
-  City Boundary

Printed on 2020/12/04  
**Land Use Constraints**  
**R11**  
 NE¼ Sec2 38-27-W4