





**ANDERS EAST**

**(Victoria Park)**

RED DEER  
**ANDERS EAST  
 OUTLINE PLAN  
 SHOWING  
 SUBDIVISION  
 OF THE  
 S.E.1/4, 10-38-27-W4**  
 FOR  
**ANDERS EAST  
 DEVELOPMENTS LTD.**

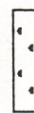
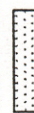
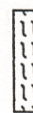
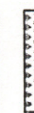
SCALE: 1:1500

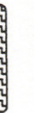
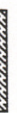
-  SINGLE FAMILY DETACHED - R1
-  WALKWAYS AND LOCAL PARKS
-  NEIGHBOURHOOD COMMERCIAL
-  SCHOOL/PARK SITE
-  DUPLEX LOTS
-  MULTI-FAMILY RESIDENTIAL
-  TWO STOREY RESIDENTIAL WITH WALKOUT BASEMENTS PERMITTED
-  MINOR COLLECTOR MEDIANS
-  P.U.L. LOTS
-  EXISTING PHASE BOUNDARIES

ALL ROADS ARE 16m UNLESS OTHERWISE NOTED.

COUNCIL ADOPTION: JULY 9, 1990  
 MAY 29, 1995  
 SEPT. 25, 1995  
 MARCH 10, 1997  
 JUNE 1, 1998

PRINTED: CAD FILE: \PROJ\AND-PL\AND-POS-BX11

PREPARED BY: **AL-TERRA**  
 ENGINEERING LTD.  
 Edmonton Red Deer

IN ASSOCIATION WITH:  
**Markenitz Associates**  
 Consulting Group Limited

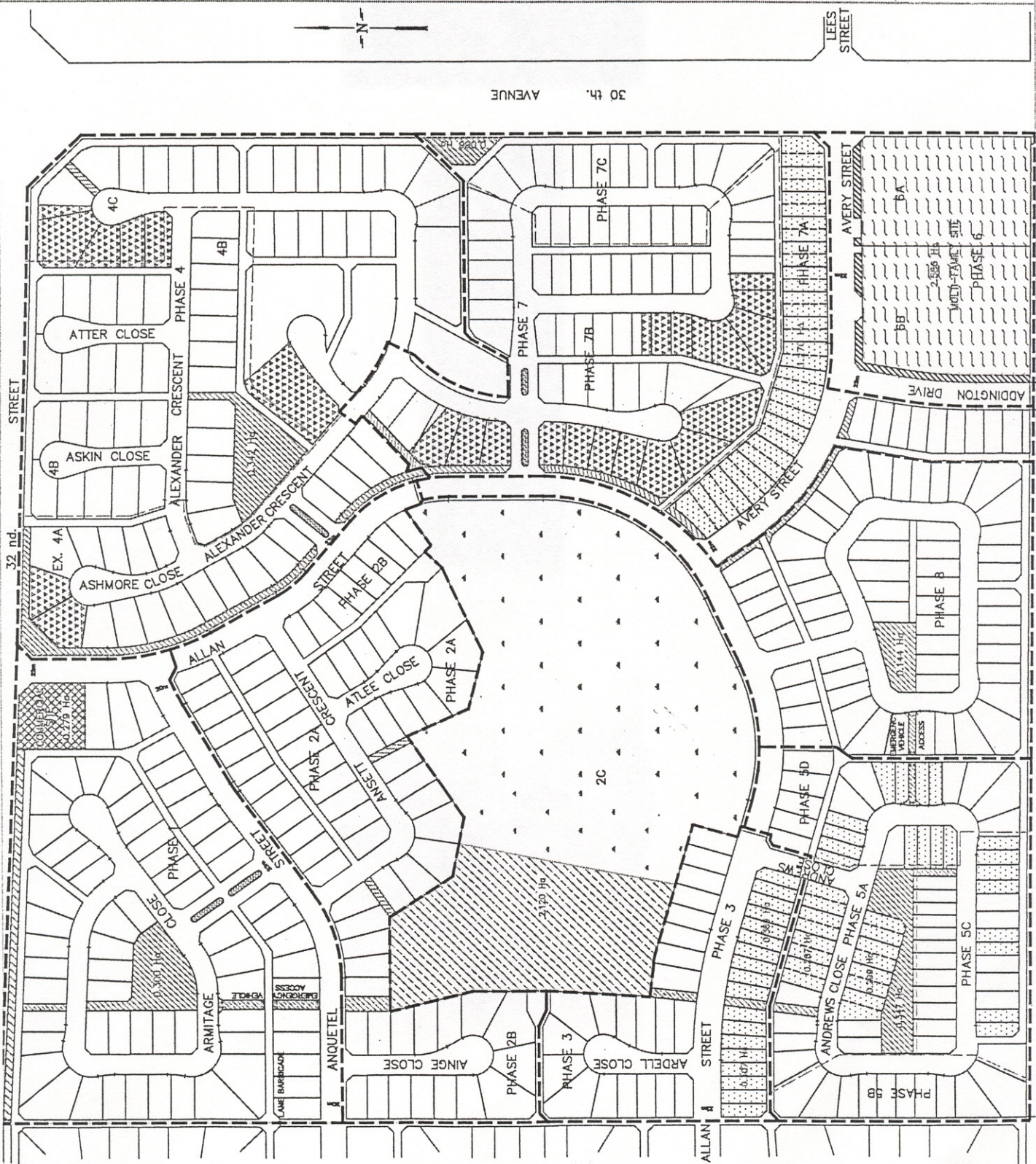

32 nd. STREET

30 ft. AVENUE

LEES STREET

ADDINGTON DRIVE

PHASE 6  
 PHASE 5  
 PHASE 4  
 PHASE 3  
 PHASE 2  
 PHASE 1

PHASE 7A  
 PHASE 7B  
 PHASE 7C

PHASE 7

PHASE 4  
 PHASE 3  
 PHASE 2

PHASE 2A  
 PHASE 2B  
 PHASE 2C

PHASE 3  
 PHASE 3A  
 PHASE 3B  
 PHASE 3C

PHASE 3D  
 PHASE 3E  
 PHASE 3F

PHASE 3G  
 PHASE 3H  
 PHASE 3I

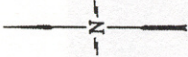

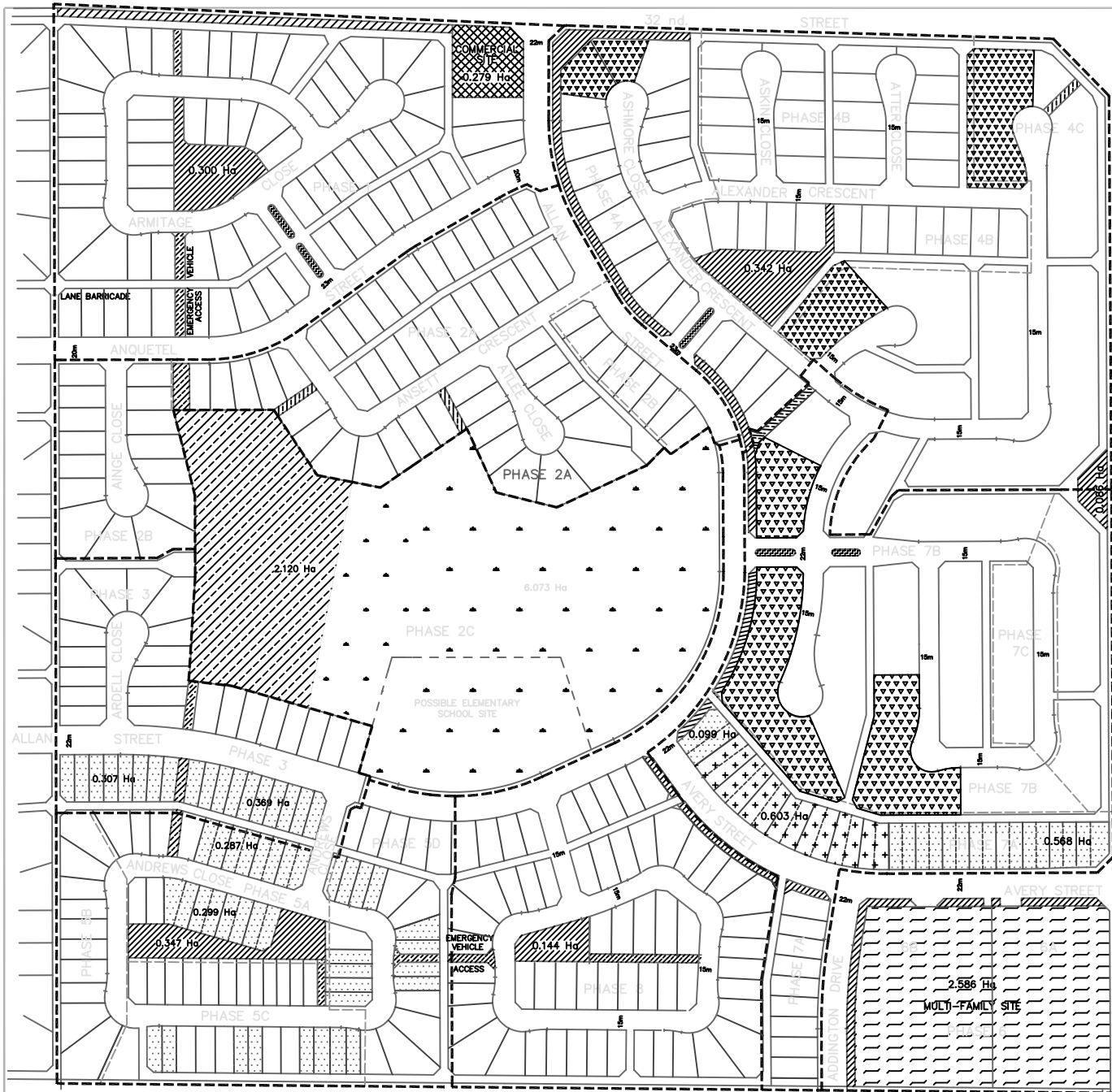

RED DEER  
**ANDERS EAST  
 OUTLINE PLAN**  
 SHOWING  
**SUBDIVISION**  
 OF THE  
**S.E.1/4, 10-38-27-W4**  
 FOR  
**ANDERS EAST  
 DEVELOPMENTS LTD.**

SCALE: N.T.S.

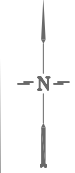

- SINGLE FAMILY DETACHED - R-1
- WALKWAYS AND LOCAL PARKS
- NEIGHBOURHOOD COMMERCIAL
- SCHOOL/PARK SITE
- DUPLEX LOTS - R-1(A)
- SINGLE FAMILY NARROW LOTS - R-1(N)
- MULTI-FAMILY RESIDENTIAL
- TWO STOREY RESIDENTIAL WITH WALKOUT BASEMENTS PERMITTED
- MINOR COLLECTOR MEDIANS
- P.U.L. LOTS

EXISTING PHASE BOUNDARIES

ALL ROADS ARE 16m UNLESS OTHERWISE NOTED.

PREPARED: MAR.8,1990  
 REVISIONS: JUNE 01,1990 FEB 18,1997  
 JUNE 24,1990 APR 08,1998  
 JUNE 27,1990 APR 30,1998  
 JULY 31,1990 MAY 15,1998  
 APR 12,1995 JUNE 08,1998  
 APR 20,1995 AUG 19,1998  
 SEPT 28,1995 NOV 24,1998  
 JAN 28,1997

PRINTED:

CAD FILE: \PROJ\S\AND-PL\AND-POS\_8x11

PREPARED BY:

**AL-TERRA**  
 ENGINEERING LTD.  
 Edmonton Red Deer

IN ASSOCIATION WITH:

**Markenzie Associates**  
 Consulting Group Limited

# ANDERS EAST SCHOOL & PARK SITE OUTLINE PLAN

REVISED PLAN  
(JUNE 1999)

