

Zoning Bylaw 3357/2024

North



Scale 1:5,000
© The City of Red Deer



	Land Use Zone Boundary		Historical Preservation Sites
	Land Use Zone		Historically Significant Sites
	Exception to Zone		Historical Site Number
	Exception Number		City Boundary
	Exempted from Zone		Civic Address
	Exempted Number		Railway
	Height Overlay Zone		Proposed Lots
	Density Overlay Zone		
	Suite Locations		

Printed on August 26, 2024

Land Use Zones

K23

NW¼ Sec4 39-27-W4

Refer to Constraints Map

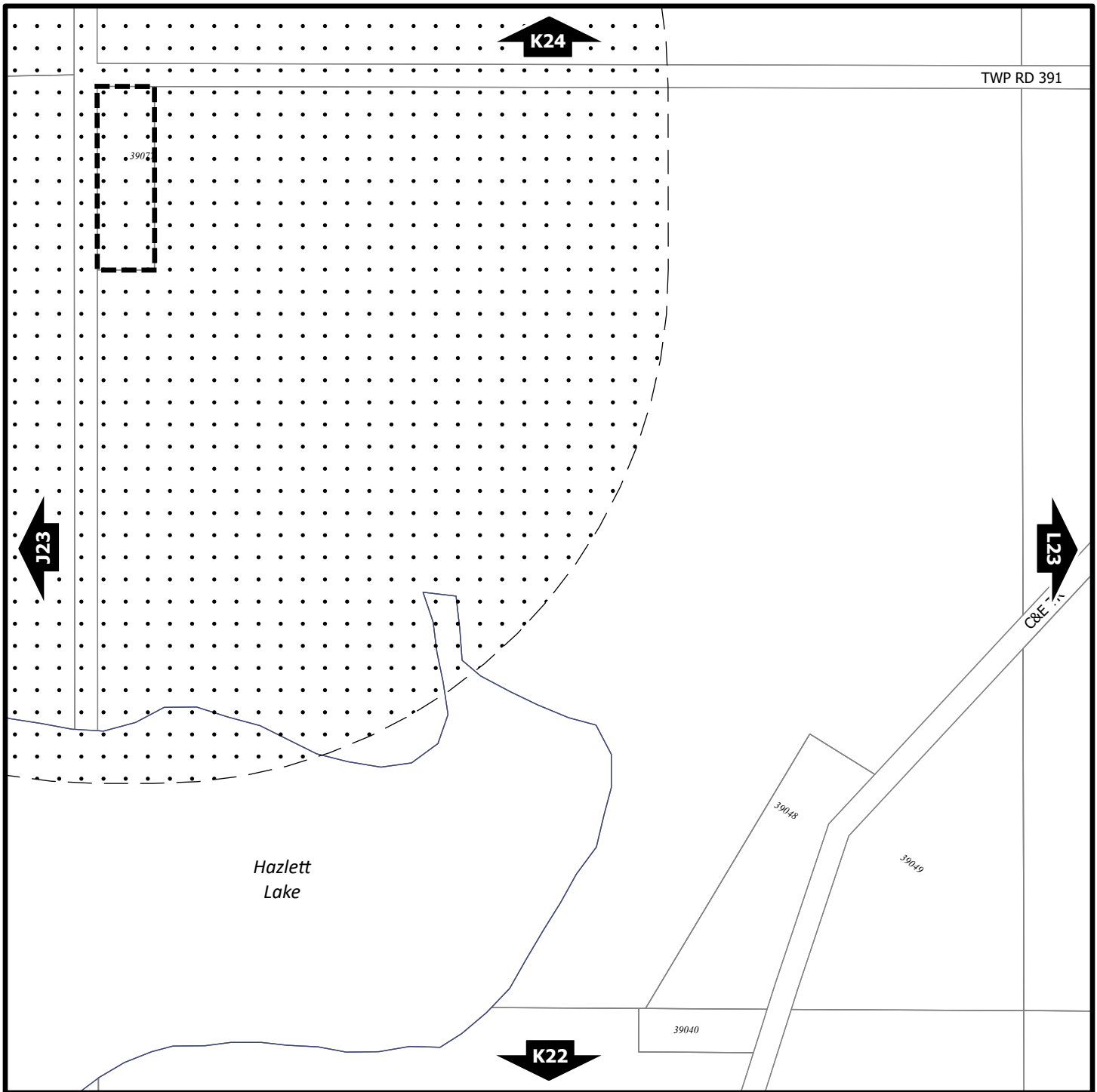

Zoning Bylaw 3357/2024

North

Scale 1:5,000
© The City of Red Deer

<p> AC AltaLink Consultation/ Potential Constraints Area</p> <p> B Business Improvement Area</p> <p> Escarpment Area</p> <p> Flood Fringe</p> <p> Floodway</p> <p> Gaetz - Ross Heritage Area</p> <p> Historical Preservation Sites</p> <p> Historically Significant Sites</p> <p> HP-32 Historical Site Number</p>	<p> Landfill Site (approximate)</p> <p> Landfill Setback</p> <p> Major Entry Area</p> <p> Overlay District</p> <p> Restricted Development Area</p> <p> Pipeline Setback</p> <p> Wastewater Treatment Plant Setback</p> <p> Railway Setback (15m)</p> <p> Railway Setback (30m)</p>
---	--

I23 Civic Address

Proposed Lots

Railway

City Boundary

Printed on August 26, 2024

Land Use Constraints

K23

NW¼ Sec4 39-27-W4