

## Zoning Bylaw 3357/2024

North



Scale 1:5,000  
© The City of Red Deer



	Land Use Zone Boundary		Historical Preservation Sites
<b>R-L</b>	Land Use Zone		Historically Significant Sites
	Exception to Zone	<i>HP-32</i>	Historical Site Number
<i>e(ii)</i>	Exception Number		City Boundary
	Exempted from Zone	<i>123</i>	Civic Address
<i>2a</i>	Exempted Number		Railway
<i>V18</i>	Height Overlay Zone		Proposed Lots
<i>D95</i>	Density Overlay Zone		
<b>S</b>	Suite Locations		

Printed on August 26, 2024

Land Use Zones

**T12**

SE¼ Sec12 38-27-W4

Refer to Constraints Map

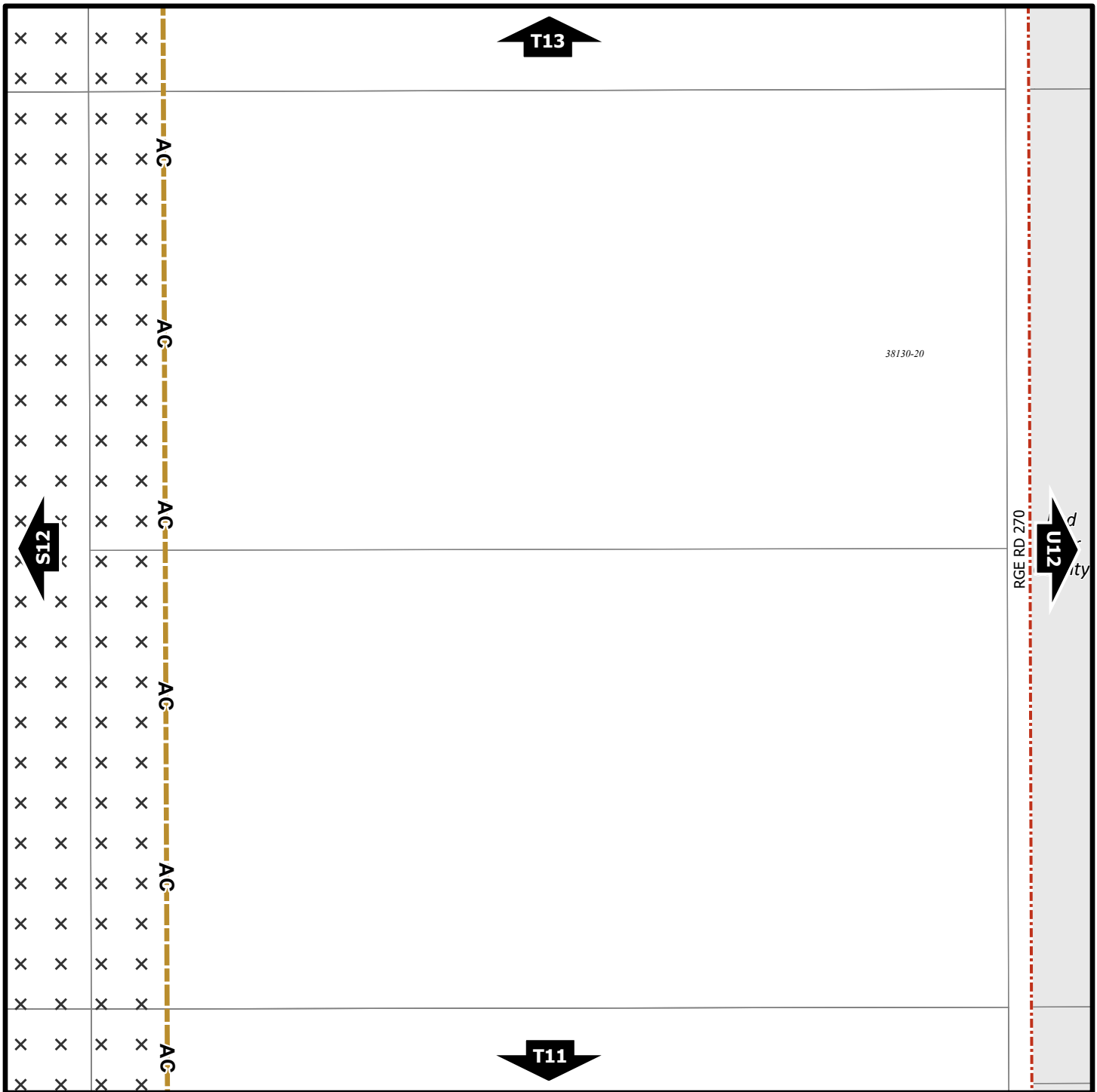

## Zoning Bylaw 3357/2024

North



Scale 1:5,000

© The City of Red Deer



	AltaLink Consultation/		Landfill Site (approximate)
	Potential Constraints Area		Landfill Setback
	Business Improvement Area		Major Entry Area
	Escarpment Area		Overlay District
	Flood Fringe		Restricted Development Area
	Floodway		Pipeline Setback
	Gaetz - Ross Heritage Area		Wastewater Treatment Plant Setback
	Historical Preservation Sites		Railway Setback (15m)
	Historically Significant Sites		Railway Setback (30m)
	HP-32 Historical Site Number		

123 Civic Address

--- Proposed Lots

++++ Railway

--- City Boundary

Printed on August 23, 2024

Land Use Constraints

**T12**

SE¼ Sec12 38-27-W4