

**ACCESSORY BUILDING**  
**APPLICATION DETAIL SHEET**

Civic Address: \_\_\_\_\_

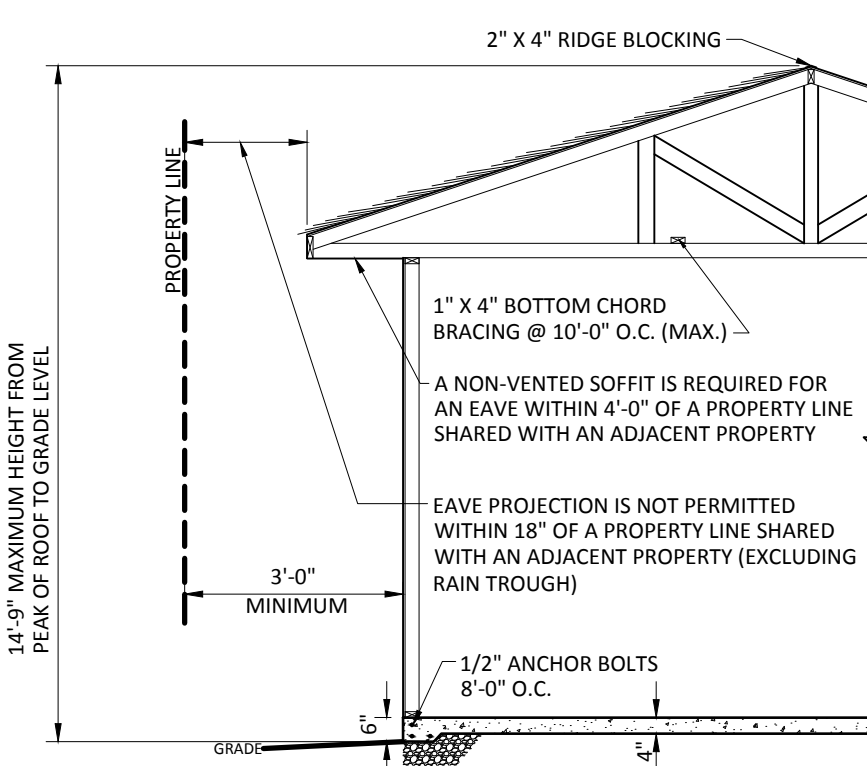

\*NOTE: 6" CLEARANCE REQUIRED FROM BOTTOM OF UNTREATED WOOD TO GRADE OR PROVIDE EQUIVALENT BASE PROTECTION

**NOTES:**

1. A GARAGE CANNOT BE BUILT OVER AN UNDERGROUND GAS LINE.
2. ALL GARAGES MUST HAVE A PASSAGE DOOR AS AN EXIT.
3. WINDOWS ARE NOT PERMITTED IN A WALL CLOSER THAN 4'-0" TO A PROPERTY LINE SHARED WITH AN ADJACENT PROPERTY.
4. WHERE ROOF FRAMING MEMBERS TRANSFER LOADS TO THE OVERHEAD DOOR BEAM ("HEADER") THE MINIMUM SIZE IS:
  - 2 PLY 2 X 10 FOR UP TO 9'-6" OPENING
  - 4 PLY 2 X 12 FOR UP TO 16'-6" OPENING
  - 3" END BEARING REQUIRED
  - ENGINEERED BEAMS MAY BE SUBMITTED IF A SUPPLIER LETTER AND DETAILS ARE SUBMITTED WITH APPLICATION.
5. WHERE ROOF FRAMING MEMBERS DO NOT TRANSFER LOADS TO THE OVERHEAD DOOR BEAM (HEADER) THE MINIMUM SIZE IS:
  - 2 PLY 2 X 8 FOR UP TO 9'-6" OPENING
  - 2 PLY 2 X 12 FOR UP TO 18'-6" OPENING
  - 3" END BEARING REQUIRED
6. ACCESSORY BUILDING TO BE INSPECTED AFTER FRAMING **BUT BEFORE** SIDING, INTERIOR INSULATION AND FINISHING.

**COMPLETE BELOW**

FOUNDATION OPTIONS FOR DETACHED GARAGE

- UP TO 592 sq.ft** - MAY BE SUPPORTED ON A PRESSURE TREATED MUD SILL OR 4" CONCRETE SLAB
- UP TO 728 sq.ft** - WITH NO DIMENSION GREATER THAN 30'-0" MAY BE SUPPORTED ON A 4" CONCRETE SLAB WITH 12" X 12" THICKENING AROUND THE PERIMETER WITH THREE ROWS OF 15mm REINFORCING. PERIMETER SLAB TO BE PLACED ON UNDISTURBED SOIL. (AS ILLUSTRATED BELOW)

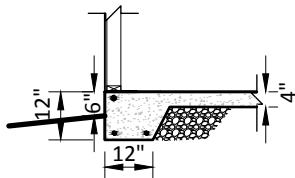

- OVER 728 sq.ft** - ENGINEER-STAMPED SITE SPECIFIC DESIGN OR 4'-0" FOUNDATION WALL ON A STRIP FOOTING.

WALL FRAMING

- 2 X 4 @ 16" O.C.
- 2 X 4 @ 24" O.C.
- 2 X 6 @ 16" O.C.
- 2X 6" @ 24" O.C.
- INSULATED WALLS AND CEILINGS
- INTERIOR FINISH (DRYWALL, ETC.)
- OTHER (e.g. CONCRETE BLOCK WALL, STRUCTURAL INSULATED PANEL (S.I.P.))

WALL SHEATHING

- 3/8" OSB/PLYWOOD
- 1/2" OSB/PLYWOOD
- OTHER \_\_\_\_\_

EXTERIOR WALL FINISH

- VINYL SIDING
- CEMENT BASED STUCCO
- METAL SIDING
- OTHER \_\_\_\_\_

TYPE OF ROOF

- GABLE
- COTTAGE
- FLAT

ROOF FRAMING

- PRE-MANUFACTURED ENGINEERED TRUSS
- ANY OTHER ROOF REQUIRES CONSTRUCTION DRAWINGS (e.g. STICK FRAME, I-JOIST, STRUCTURAL INSULATED PANELS (S.I.P.))

ROOF SHEATHING

- 7/16" OSB
- OTHER \_\_\_\_\_

ROOF MATERIALS

- ASPHALT SHINGLES
- CEDAR, PINE SHAKES AND SHINGLES
- METAL ROOFING
- OTHER \_\_\_\_\_

DIRECTION OF TRUSSES

- TRUSSES PARALLEL TO OVERHEAD DOOR OPENING
- TRUSSES PERPENDICULAR TO OVERHEAD DOOR OPENING

GARAGE DOOR BEAM

- LENGTH \_\_\_\_\_
- DEPTH \_\_\_\_\_
- \_\_\_\_\_ # of PLYS
- BUILT UP
- ENGINEERED

INTERIOR DEVELOPMENT

NOTE: A SEPARATE PERMIT IS REQUIRED FOR EACH OF THESE SERVICES (IF APPLICABLE)

- ELECTRICAL
- GAS
- HEATING
- PLUMBING